

Busbar Insulation End Caps

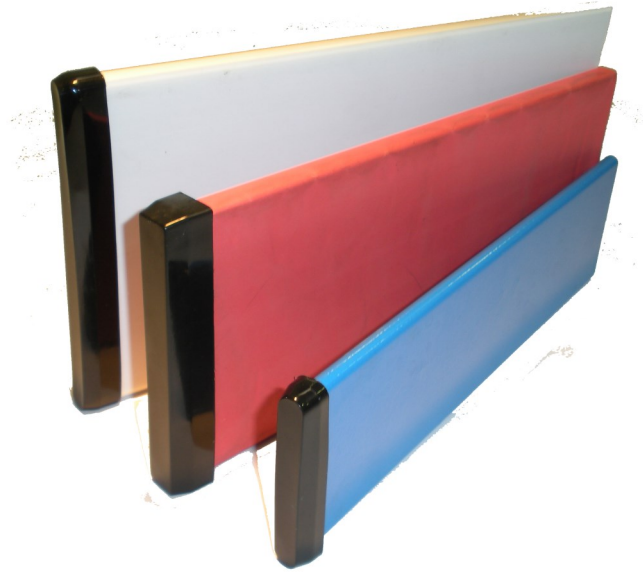

Use

The END CAPS insulate the ends of the busbars. Busbars may be full radius or square edged. The angled openings are designed to accommodate busbars that are insulated by -

- KENTAN type rigid sleeving
- Heat-shrink sleeving
- Powder coating

The END CAPS are made for all standard sizes of busbars, 6.35 and 10 mm thick.

Colour

Black. (Other colours may be made to special order).

Material Details

Product Name	Flexible PVC compound
Flammability	UL94-VO (self extinguishing)
Tensile Strength	≥ 13.0 Mpa GB 1040
Elongation at Break	≥ 250 381% GB 1040

Compliance to Standards

The END CAPS are intended to be glued in place (superglue is recommended) to comply with the following clauses of AS/NZS 3439.1 : 2002 7.4.2.1 Protection by insulation of live parts :

- Live parts shall be completely covered with insulation which can only be removed by destruction or by use of a tool.
- Flame retardant PVC, 1.6 mm thick.

Dimensions

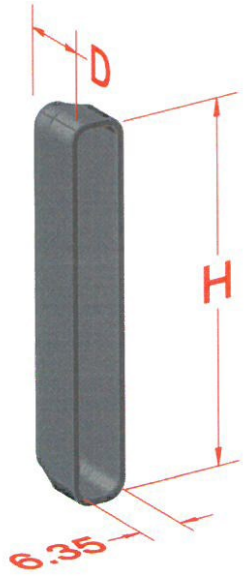

Busbar Dimensions		
Thickness	Height	Depth
6.35	25	11
	32	
	40	
	50	
	63	
	80	15
	100	
	160	

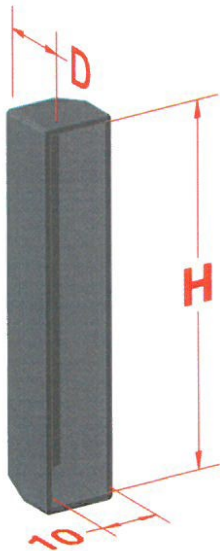

Busbar Dimensions		
Thickness	Height	Depth
10	25	11
	30	
	40	
	50	
	60	
	80	15
	100	
	120	
	160	

KENTAN ENGINEERING

A.B.N 21 009 217 654

Unit 3, 8 Carole Road
MADDINGTON Western Australia 6109

P.O Box 284
MADDINGTON Western Australia 6989

International Telephone: 61 8 9493 5255

National Telephone: (08) 9493 5255

Facsimile: (08) 9493 5242

E-Mail: sales@kentan.com.au

Internet: www.kentan.com.au



Kentan Engineering is a Quality Assured Company